

NorDan UK Ltd
3 Almondview Office Park
Livingston
EH54 6SF

Tel: 01506 433173
e-mail: info@nordan.co.uk
website: www.nordan.co.uk



Agrément Certificate
07/4476 (ES1)

ENHANCED SECURITY FOR PRODUCT SHEET 1

NORDAN 1I, TE AND TX TIMBER DOORSETS

This Enhanced Security sheet is not valid in isolation and must be read in conjunction with Product Sheet 1 of this Certificate. The information in this sheet supplements the details given in Product Sheet 1, section 9 *Unauthorised access*.

- *The details in this sheet are only relevant to inward and outward opening single-leaf doorsets and outward opening double-leaf doorsets supplied by NorDan UK Ltd and meeting the specification defined in section 2 Scope of approval*
- *It is essential that the doorsets are installed in accordance with the recommendations contained in Product Sheet 1 and in the manufacturer's instructions to achieve the standard of enhanced security defined in this sheet.*



1 General

Selected doorsets from the NorDan timber inward opening (1I) and outward opening (TE and TX) door range covered by Product Sheet 1 were tested to PAS 24 : 2016, Annexes A and B *Enhanced security performance requirements for doorsets and windows in the UK — Doorsets and windows intended to offer a level of security suitable for dwellings and other buildings exposed to comparable risk* and are classified D.

2 Scope of approval

2.1 The specification for the doors considered to offer enhanced security comprises doors with 26 or 27 mm glazing units, all fabricated from components as listed in Table 1, and in accordance with the recommendations contained on the NorDan website (www.nordan.co.uk). See also Figures 1 and 2.

2.2 The scope of the test programme does not cover glass breakage as a means of entry. In locations where this is considered to be a significant risk, the use of laminated glass or other suitable glazing material may be necessary or required by Secured by Design (SBD) schemes.

3 Design features

Externally fitted aluminium glazing beads can be removed by manipulation but the subsequent removal of the glass without breakage and noise is extremely difficult due to the glazing being additionally secured by polyurethane adhesive sealant.

4 Design considerations

4.1 Only the specification of doors referred to in section 2.1 can be considered to meet the requirements. Any design variations to the frame profiles, locking mechanisms, handles, keeps, striker plates or associated fasteners will require the door to be retested.

4.2 To ensure the level of resistance to intrusion indicated by the tests is achieved, installation must be carried out in accordance with the recommendations contained in Product Sheet 1 and the Certificate holder's instructions. For example, fixing of the door into the opening is vital.

4.3 Doors assessed for enhanced security are designed to resist attempts to forced entry by the opportunist intruder using basic hand tools. However, the scope of assessment does not extend to an assurance of absolute security. In addition, door security must be considered in the context of the overall security of the building, taking into account such factors as vulnerability of individual doors and the security of windows.

The BBA has awarded this Certificate for Enhanced Security to PAS 24 to the company named above for the door systems described herein provided they are installed, used and maintained as set out in this Certificate.

On behalf of the British Board of Agrément

Date of Fifth issue: 20 January 2021

Originally certificated on 26 September 2007

Hardy Giesler
Chief Executive Officer

The BBA is a UKAS accredited certification body – Number 113.

The schedule of the current scope of accreditation for product certification is available in pdf format via the UKAS link on the BBA website at www.bbacerts.co.uk

Readers MUST check the validity and latest issue number of this Agrément Certificate by either referring to the BBA website or contacting the BBA directly.

Any photographs are for illustrative purposes only, do not constitute advice and should not be relied upon.

*Table 1 Single-leaf (TE) and double leaf (TX) outward opening or single leaf (1I) inward opening doorsets
— list of furniture and fittings*

Application	Manufacturer's designation⁽¹⁾
Fix 5-point locking espagnolette (3 dead locks, 1 hookbolt and a centre latch)	0401259 0401261 0401263 0401265 0401267 0401271 0401273 0401275
3 deadlock keeps	0400363
Centre hook bolt keep	0401307
3 or 4 door hinges	0400006 to 0400009 0400020 to 0400023
Handle (white, chrome or brass)	0401704 0401705 0401706 0401710 0401711 0401712
Cylinder (blanking plate/thumbturn) (blanking plate/key) (key/thumbturn) (key/key)	Trioving 2-part cylinder 0401690 and 0401691 0401692 and 0401693 0401694 and 0401695 0401696 and 0401697
Insulated timber panel 5.5 mm HDF/35 mm — 37 mm closed-cell extruded polystyrene foam/5.5 mm HDF	—

(1) These items may be unmarked and it is recommended that, if in doubt, the purchaser seeks written assurance of the component specifications from the Certificate holder.

Figure 1 Typical vertical section of an inward opening (I) door

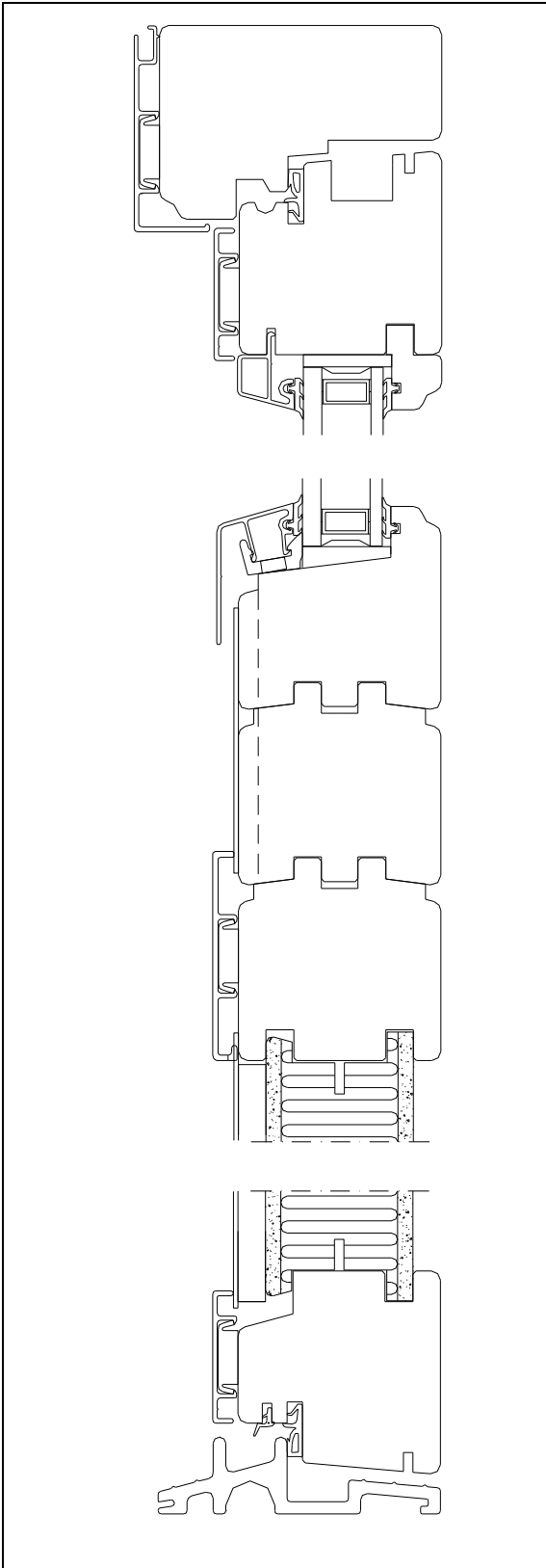
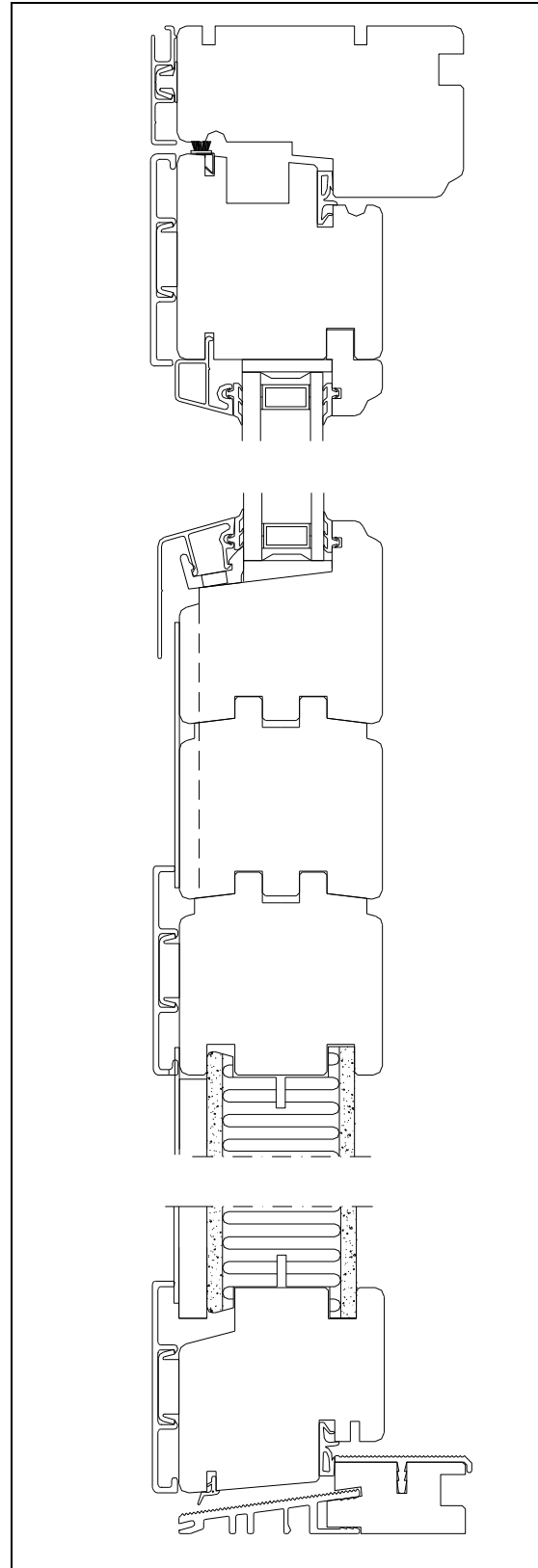

Figure 2 Typical vertical section of an outward opening (TX) door



British Board of Agrément
Bucknalls Lane
Watford
Herts WD25 9BA

©2021

tel: 01923 665300
clientservices@bbacerts.co.uk
www.bbacerts.co.uk